

Notion Job Aid

Connecting GitHub to Notion AI for Enterprise Search

Overview

This job aid walks you through adding GitHub as an AI Connector in Notion, so Notion AI can search across your GitHub repositories alongside your Notion pages. The same flow works for the other Notion AI Connectors (Slack, Linear, Jira, Microsoft Teams, SharePoint, etc.) The only thing that changes is the third-party authorization screen at the end.

Some connectors are gated by the third-party platform. They require the *third-party* account to be on a paid, admin-managed plan rather than a free personal account, and the install must be performed by an admin on that side. The Google Drive connector, for example, requires a paid Google Workspace account (a personal gmail.com cannot install it), and the install has to be triggered by a Google Workspace admin.

What you will do

- Open Notion settings and find the AI connectors tab.
- Click + next to GitHub to start the install.
- Sign in to GitHub and install the Notion AI Connector GitHub App on your account.
- Confirm the connector shows as installed in Notion.

Before you start, you will need

- A Notion workspace where you are the Workspace Owner or Admin (only owners/admins can add workspace AI connectors).
- A Notion plan that includes AI connectors (Business or Enterprise).
- A GitHub account that owns or has access to the repositories you want indexed.
- Either the Notion desktop app (used in this guide) or notion.so in your browser.

This job aid uses the Notion desktop interface.

A note about the AI connector being available

After install, Notion shows that "It may take up to 72 hours" for content to appear in AI search. Each member of the workspace must also authenticate to GitHub once before they can see any AI answers about GitHub content — GitHub permissions are strictly respected, so a member only ever sees results from repos they could already access on GitHub.

Step 1 — Open Notion Settings

1. Open the Notion desktop app and make sure the workspace selector at the top-left is on the workspace where you want the connector (in this example, "Ershin Sand's Space").
2. Press $\text{⌘} + \text{,}$ (Cmd + comma) on Mac, or $\text{Ctrl} + \text{,}$ on Windows. The Settings panel opens.

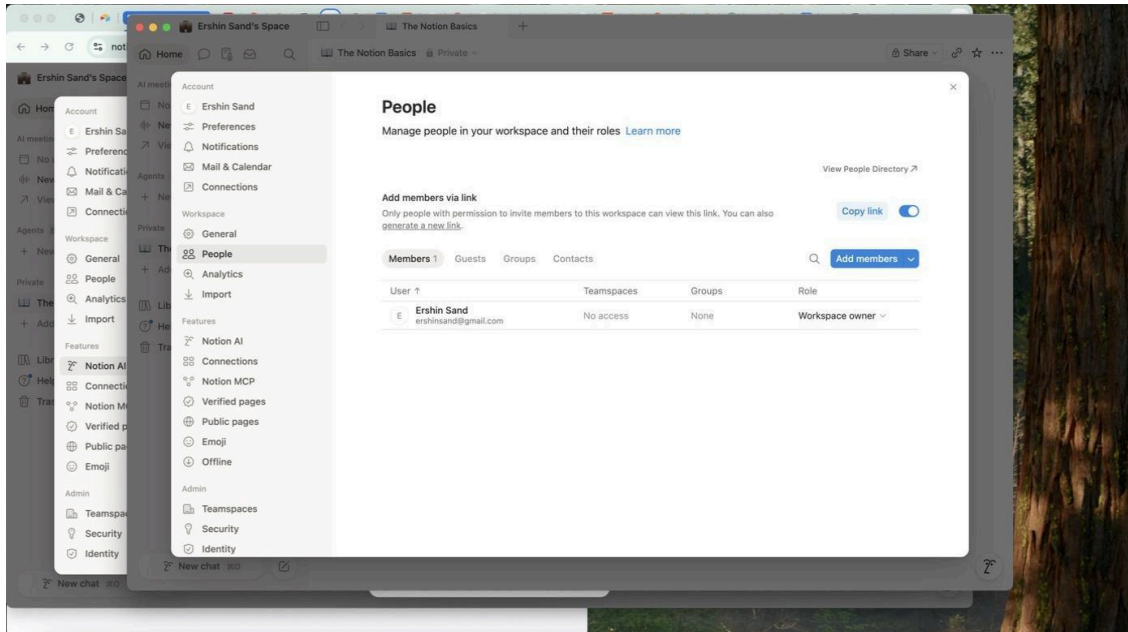

Step 2 — Open the Notion AI section

In the Settings sidebar, find the Features group near the bottom. Click "Notion AI" — this is where workspace-level AI features and connectors live.

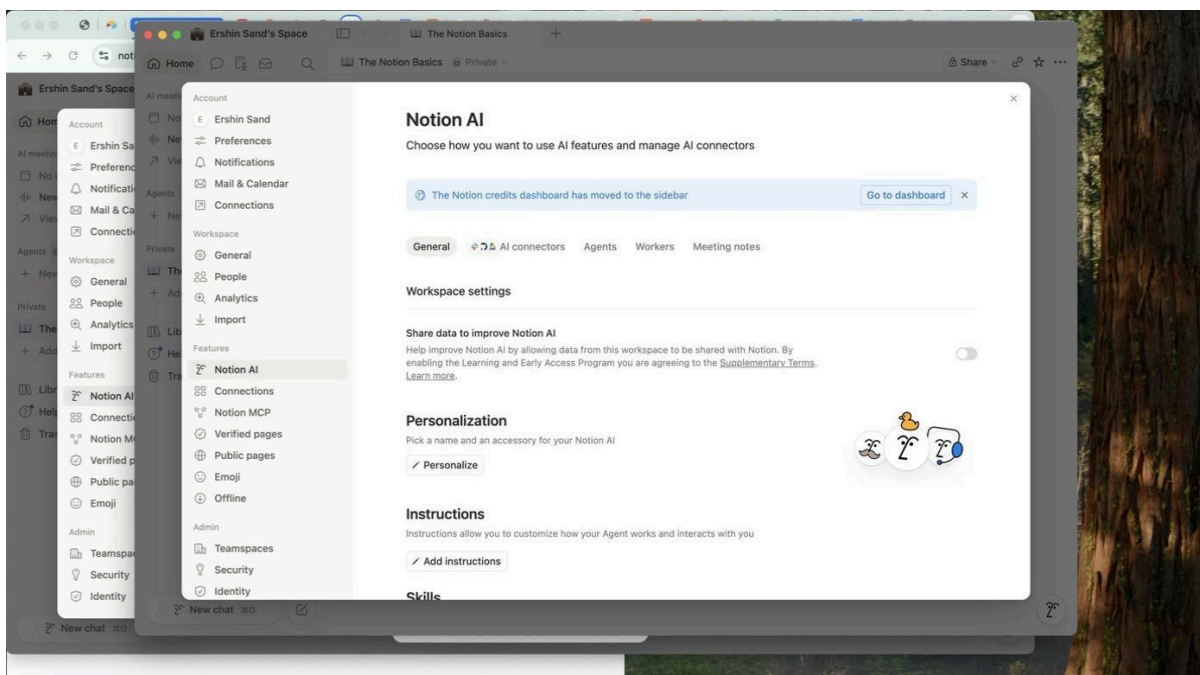

Step 3 — Switch to the AI connectors tab

Across the top of the Notion AI page there are tabs: General, AI connectors, Agents, Workers, Meeting notes. Click the AI connectors tab.

You see a grid of "Workspace AI connectors" you can add: Asana, Box, GitHub, Gmail, Google Calendar, Google Drive, Jira, Linear, Microsoft Teams, Outlook, Salesforce, SharePoint, and Slack. Each row has a + button on the right.

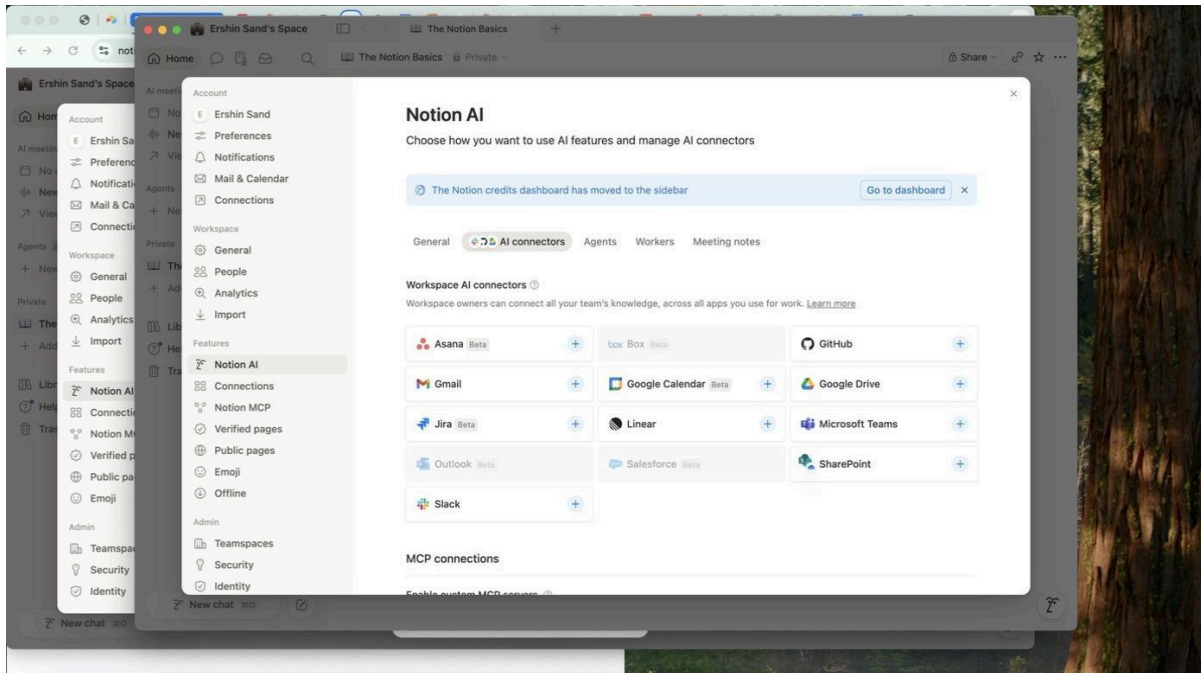

Workspace AI connectors — click the + next to GitHub.

Step 4 — Click + next to GitHub

Click the + button on the GitHub row. Notion shows a confirmation dialog that explains what is about to happen:

- GitHub will open in a new browser tab.
- GitHub permissions are strictly respected — members only see content they are authorized to see in GitHub.
- Notion does not train models on your GitHub data.

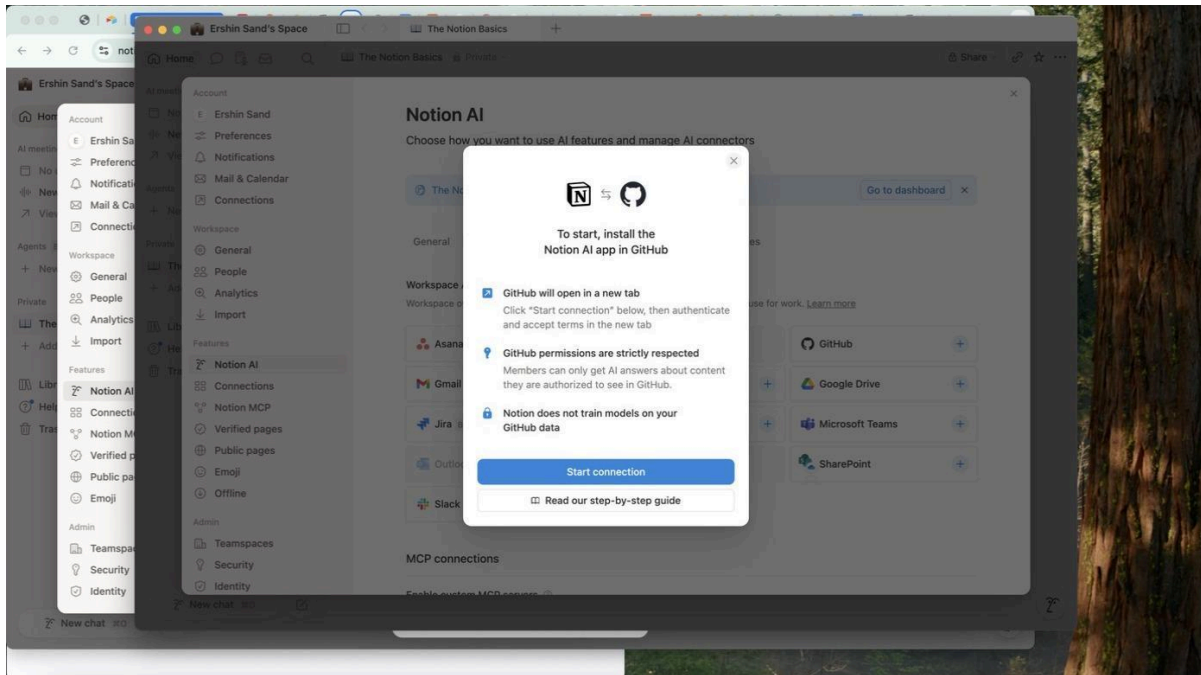

"To start, install the Notion AI app in GitHub" — click Start connection.

Click Start connection. Notion launches a new browser tab to GitHub.

Step 5 — Sign in to GitHub

In the new browser tab, GitHub asks you to sign in. The page says "Sign in to GitHub to continue to Notion AI Connector".

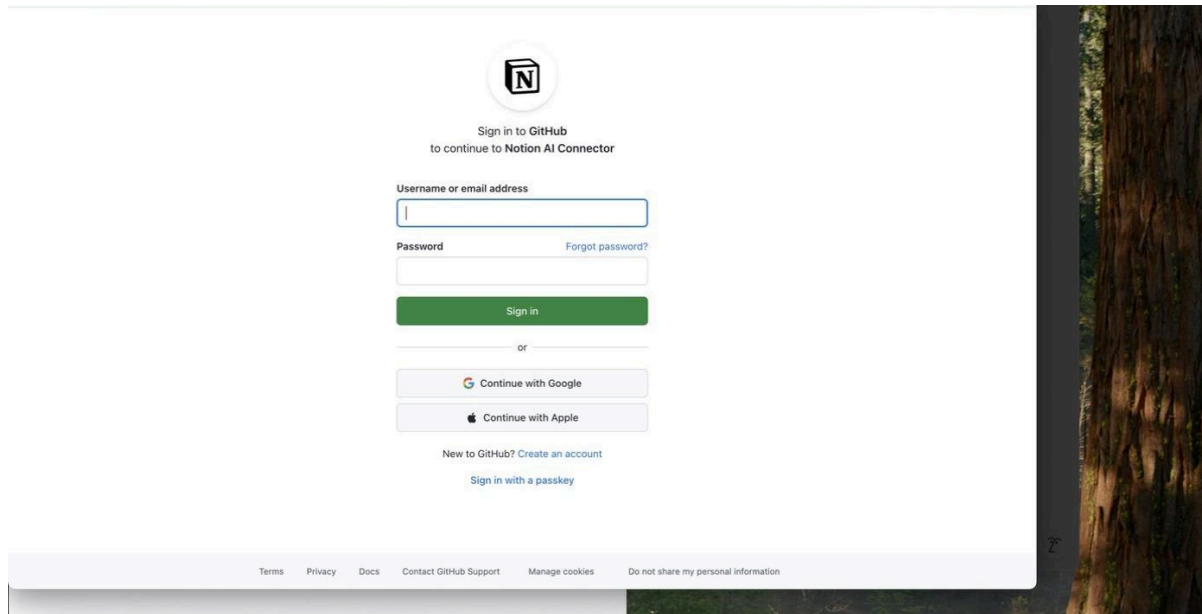

Sign in to GitHub — use your username/email and password (or Continue with Google / Apple / passkey).

Enter your GitHub username or email and password and click Sign in. If you have two-factor authentication, complete the 2FA challenge. If your browser had you signed in already, GitHub may skip this step.

Tip — returning to the Notion app while GitHub finishes

While the browser tab is open, the Notion app shows a holding screen titled "Follow instructions from GitHub in your browser". You can ignore this for now. Once you finish the install in GitHub, Notion will update automatically. If GitHub did not open, click "click here to retry" on this screen.

Step 6 — Install the Notion AI Connector on GitHub

After signing in, GitHub shows the Install screen for the Notion AI Connector GitHub App.

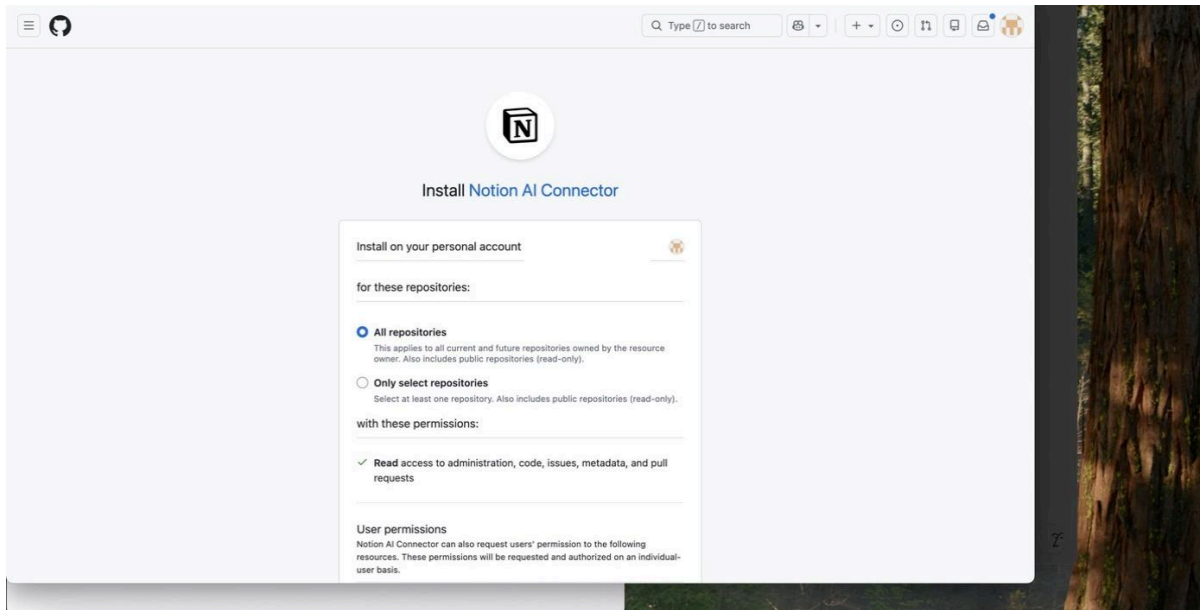

GitHub install page — "Install on your personal account".

6a. Choose which repositories to index

Two radio buttons let you choose:

- **All repositories** — applies to all current and future repositories the account owns. Includes public repositories (read-only). This is the default.
- **Only select repositories** — lets you pick a list of repos. Choose this if you only want a subset indexed.

For most users, "All repositories" is the right choice. The connector only requests Read access to administration, code, issues, metadata, and pull requests, it cannot make changes.

6b. Click Install

Scroll to the bottom of the GitHub page and click the green Install button. GitHub may prompt you to confirm your password as a final security check before installing the app. After install, GitHub redirects you back to the Notion app automatically.

Step 7 — Confirm the connector is installed in Notion

Notion shows a "You're done!" confirmation modal. It explains what to expect next:

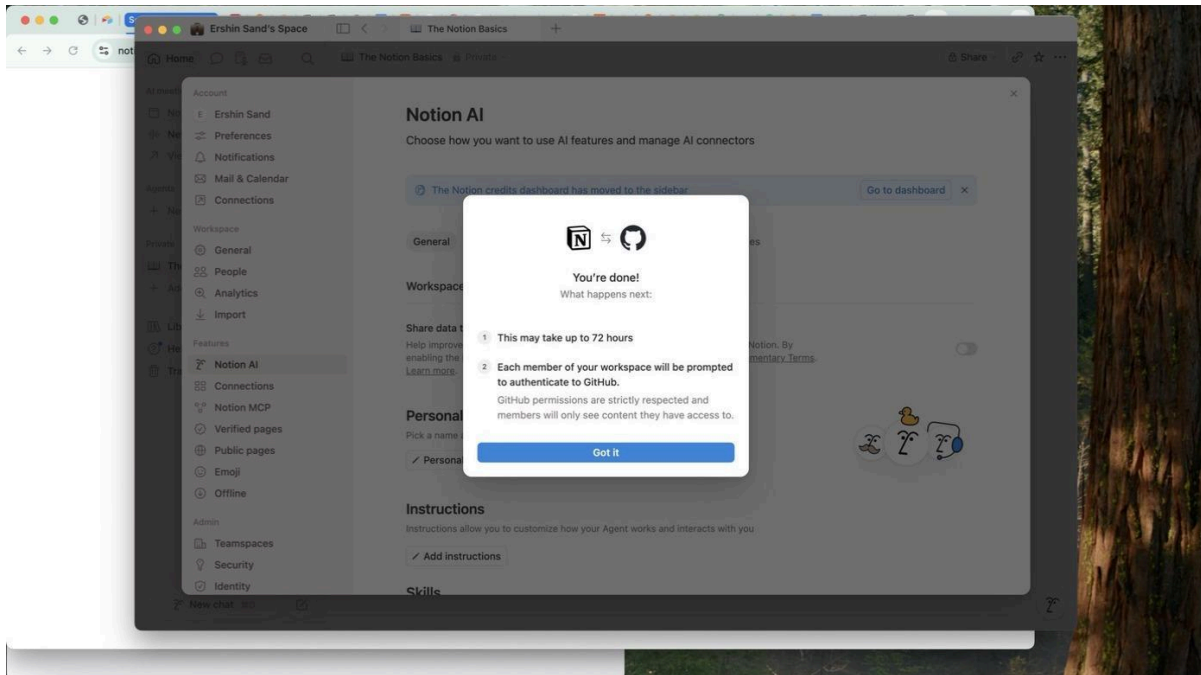

Notion confirms the GitHub connector is installed.

- It may take up to 72 hours for content to start appearing in AI search.
- Each member of the workspace will be prompted to authenticate to GitHub the first time they try to use the connector. Until they do, they will not get GitHub-based AI answers.

Click Got it to dismiss the modal.

Step 8 — Verify GitHub appears in your AI connectors

Back on Settings → Notion AI → AI connectors, GitHub now sits in the same Workspace AI connectors grid. Re-opening this page is also where you go to remove or reconfigure the connector later.

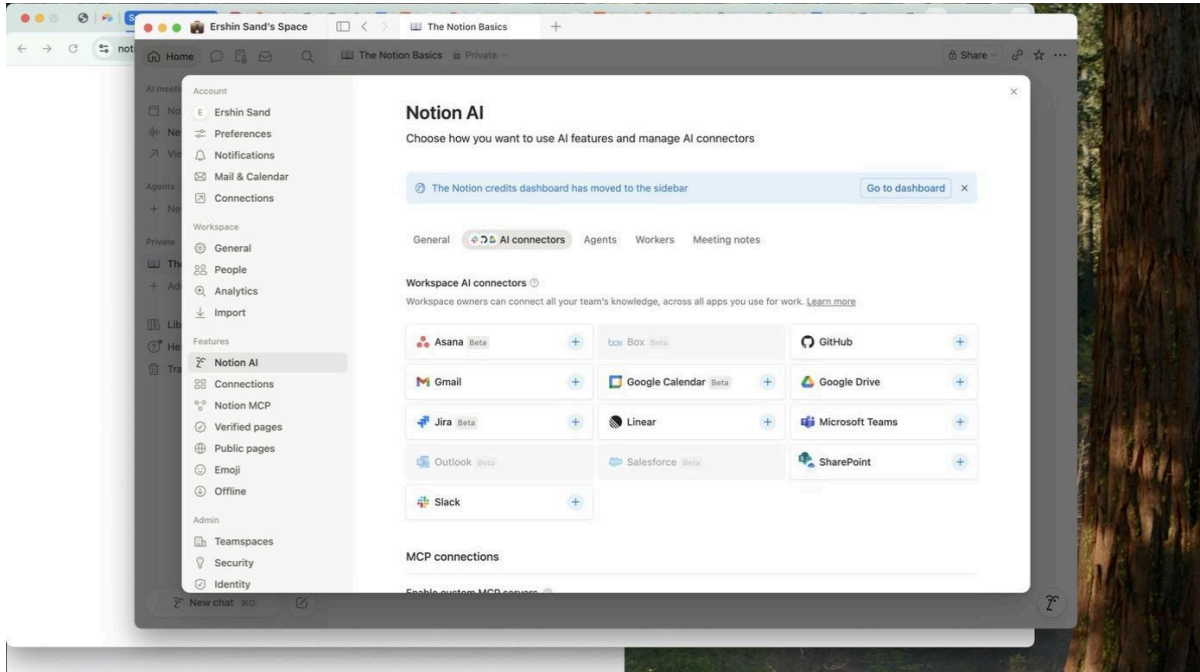

Final state — GitHub is installed at the workspace level.

Step 9 — Try it out (after sync completes)

- Open Notion AI from any page, or use the search bar in the top of the workspace.
- Ask a question that is most likely to be answered from your GitHub repos, e.g. "What changed in the README of my repo X this week?" or "Find pull requests about authentication."
- In the source filters at the top of the AI search results, you should see a GitHub filter you can click to limit the results to GitHub.
- If you do not see GitHub-sourced answers right away, give it up to 72 hours to finish the initial sync, and make sure you have completed the per-user GitHub authentication when Notion prompts you the first time.

Tips and troubleshooting

- "To start, install the Notion AI app in GitHub" reappears every time you click the + button on the GitHub row. That is normal — it always reuses the same dialog.
- If the GitHub redirect URL ever shows "errorMessage=..." in the address bar, GitHub returned an error. Close the browser tab, return to Notion, and click "click here to retry" in the holding screen to start fresh.
- Some connectors are gated by the third-party platform — they require the third-party account to be on a paid, admin-managed plan rather than a free personal account, and

the install must be performed by an admin on that side. The Google Drive connector, for example, requires a paid Google Workspace account (a personal gmail.com cannot install it), and the install has to be triggered by a Google Workspace admin. GitHub does not have this restriction — a personal GitHub account can install the connector directly, which is why this guide works on a personal GitHub.

- To remove the connector later, return to Settings → Notion AI → AI connectors, click on the connector's row, and use the disconnect option, then uninstall the GitHub App from github.com/settings/installations as well.
- Members must each go through the per-user authentication flow once before they can see GitHub-sourced answers. They will be prompted automatically the first time they search.